

JRW CAST IRON CHECK VALVE (L.W.)

BS5153 PN16

- Design and Manufacture Conform to BS5153
- Flange dimensions Conform to BS4504 PN16
- Face to Face dimensions Conform to BS5153 PN16
- Testing Conform to BS6755

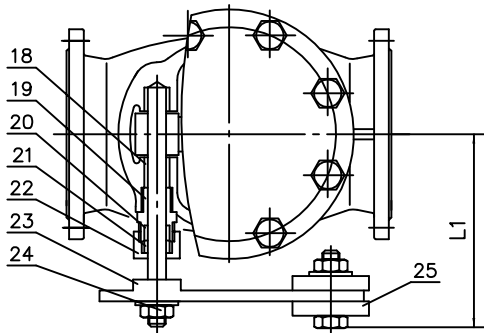
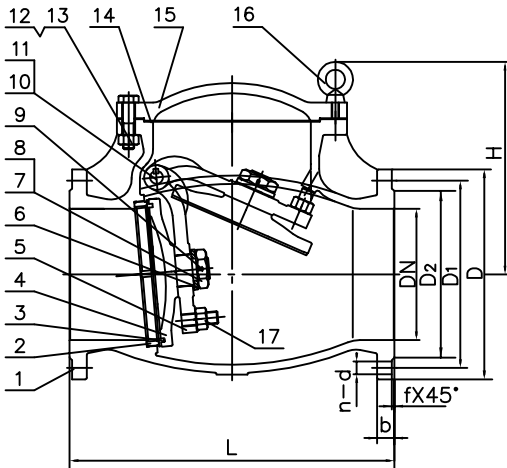

MATERIALS

NO.	PART NAME	MATERIAL(C.I.)	MATERIAL(D.I.)
1	BODY	ASTM A126 B	ASTM A536
2	SEAT RING	ASTM B62 or 13Cr	ASTM B62 or 13Cr
3	DISC SEAL RING	ASTM B62 or 13Cr	ASTM B62 or 13Cr
4	DISC	ASTM A126 B	ASTM A536
5	HINGE	ASTM A216 WCB	ASTM A216 WCB
6	WASHER	CARBON STEEL	CARBON STEEL
7	NUT	CARBON STEEL	CARBON STEEL
8	STUD	CARBON STEEL	CARBON STEEL
9	SPLIT PIN	304	304
10	HINGE PIN	13Cr	13Cr
11	KEY	CARBON STEEL	CARBON STEEL
12	BOLT	CARBON STEEL	CARBON STEEL
13	NUT	CARBON STEEL	CARBON STEEL
14	BONNET GASKET	GRAPHITE+STEEL	GRAPHITE+STEEL
15	BONNET	ASTM A126 B	ASTM A536
16	EYE SCREW	CARBON STEEL	CARBON STEEL
17	ADJUSTING SCREW	CARBON STEEL	CARBON STEEL
18	BUSHING	ASTM B16	ASTM B16
19	STUFFING BOX	ASTM B16	ASTM B16
20	PACKING	GRAPHITE	GRAPHITE
21	PACKING GLAND	ASTM B16	ASTM B16
22	GLAND NUT	ASTM B16	ASTM B16
23	LEVER	CARBON STEEL	CARBON STEEL
24	NUT	CARBON STEEL	CARBON STEEL
25	WEIGHT	ASTM A126 B	ASTM A126 B

DIMENSIONS (mm)

DN	L	D	D ₁	D ₂	b	n-d	f	H	L ₁	Kg
50	203	165	125	99	20	4-19	3	153	153	20
65	216	185	145	118	20	4-19	3	162	162	24
80	241	200	160	132	22	8-19	3	176	175	33
100	292	220	180	156	24	8-19	3	220	220	48
125	330	250	210	184	26	8-19	3	226	226	63
150	356	285	240	211	26	8-23	3	256	321	82
200	495	340	295	266	30	12-23	3	298	352	136
250	622	405	355	319	32	12-28	3	376	374	207
300	698	460	410	370	32	12-28	4	410	427	315
350	787	520	470	429	36	16-28	4	444	465	528
400	914	580	525	480	38	16-31	4	501	470	716
450	965	640	585	548	40	20-31	4	698	490	831
500	1067	715	650	609	42	20-34	4	742	548	1058
600	1219	840	770	720	48	20-37	5	844	600	1660